

- NOTES:
- ALL DIMENSIONS IN MM [INCH]
 - GENERAL TOLERANCE: X.X \pm 0.4
X.XX \pm 0.25
 - TERM. NOS. FOR REFERENCE ONLY.
 - RATING: 20VDC, 100mA MAX; SPST
 - CONTACT RESISTANCE: 150 MILLI-OHM MAX.
 - INSULATION RESISTANCE: 10MEGA-OHM MIN @500VDC.
 - DIELECTRIC STRENGTH: 500VAC FOR 1 MINUTE
 - OPERATING FORCE: 250 \pm x50GF
 - OPERATING LIFE: 50,000,000 CYCLES
 - OPERATING TEMP: -5°C TO +60°C
 - STORAGE TEMPERATURE: -40°C TO +90°C
 - TOTAL TRAVEL: 3.30mm \pm 0.3
 - TRAVEL TO ELECTRICAL MAKE: 2.9 \pm 0.5MM
 - LED COLOR: RED
 - 2002/95/EC (ROHS) COMPLIANT
 - ▲ DENOTES CRITICAL PARAMETER.

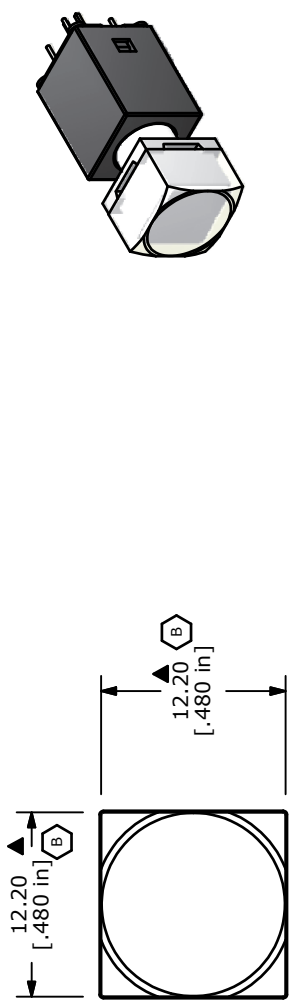

▲ CLEAR CAP WITH WHITE DIFFUSER

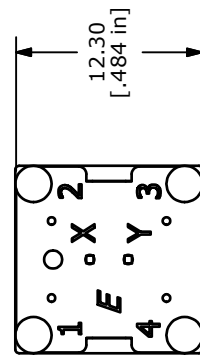
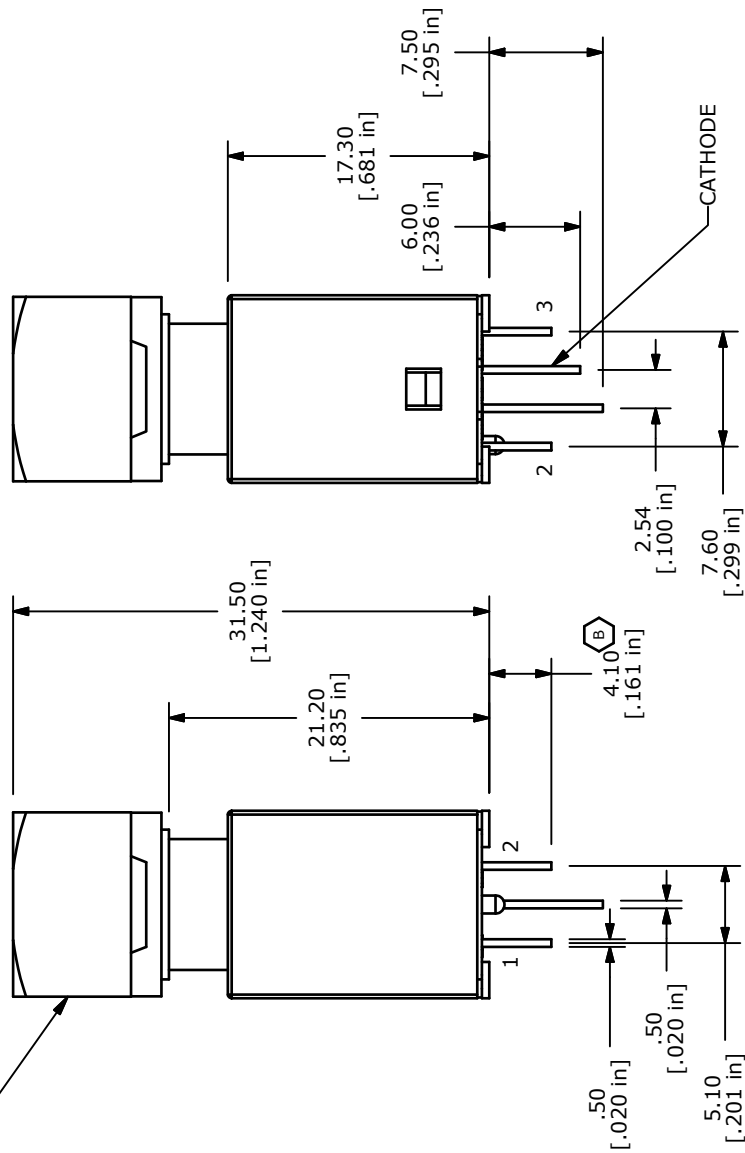

▲ LED SPECS	UNITS	RED
FORWARD CURRENT	mA	20
FORWARD VOLTAGE @20mA	V	1.95 Typ-2.5 Max
LUMINOUS INTENSITY @ .10mA	mcd	280 Typ



TITLE LP160A1ASTWR

B	19592	CHANGE DIMS: was 4.2 & 12.4	1/17/11	BGL
A	19259	New Release	8/20/10	rc
REV	PCR NO	DESCRIPTION	DATE	BY

THE INFORMATION CONTAINED IN THIS DOCUMENT IS PROPRIETARY TO E-SWITCH AND IS NOT TO BE COPIED OR TRANSFERRED

SCALE 2:1 DATE 7/29/2010 DR rc

DWG B160001

REV B